



Government Regulations, Easements and Assessments Disclosure and Addendum (REA)
(Required for all Listing Agreements and Sales Contracts in Montgomery County)

The Contract of Sale dated _____, Address 5813 Ipswich Rd,
 City Bethesda, State MD Zip 20814-1807 between
 Seller Douglas Construction Group, LLC and
 Buyer _____ is hereby amended by
 the incorporation of this Addendum, which shall supersede any provisions to the contrary in the Contract.

Notice to Seller: Pursuant to Montgomery County Code (Sec.40-13), a Seller is required to fully disclose to Buyers all specific facts relevant to, or affecting any property, imposed by any law or regulation or any common law principle. Seller acknowledges he has carefully examined this form, and that the information is complete, accurate, and current to the best of his knowledge at the time of entering into a contract. This Disclosure/Addendum to be completed by the Seller shall be available to prospective Buyers prior to making a purchase offer and will become a part of the sales contract for the sale of the Property.

Notice to Buyer: The information contained herein is the representation of the Seller. Further information may be obtained by contacting staff and web sites of appropriate authorities, Montgomery County Government, 240-777-1000, Park and Planning Commission/Montgomery County Department of Park and Planning, 301-495-4700, and municipality, if applicable.

General Information:

The content in this form is not all-inclusive. Please be advised that web site addresses, personnel and telephone numbers do change and GCAAR cannot confirm the accuracy of the information contained in this form. When in doubt regarding the provisions or applicability of a regulation, easement or assessment, information should be verified with the appropriate government agency.

- **Montgomery County Government**, 101 Monroe Street, Rockville, MD, 20850. Main Telephone Number: 240-777-1000. Web site: www.montgomerycountymd.gov
- **Maryland-National Capital Area Park and Planning Commission (M-NCPPC)** 8787 Georgia Avenue, Silver Spring, MD, 20910. Main number: 301-495-4600. Web site: www.mc-mncppc.org
- **City of Rockville**, City Hall, 111 Maryland Ave, Rockville, MD 20850. Main telephone number: 240-314-5000. Web site: www.rockvillemd.gov

1. AVAILABILITY OF WATER AND SEWER SERVICE:

- **Existing Water and Sewer Service:** Refer to the Seller's Water Bills or contact WSSC at 301-206-4001 or City of Rockville at 240-314-8420.
- **Well and Septic Locations:** Contact the **Department of Permitting Services "DPS", Well and Septic**, at 240-777-6320, fax 240-777-6314 or gene.vongunten@co.mo.md.us. For septic field location for homes constructed prior to 1978, request an "as built" drawing using DPS's "Septic System Location Application" form. Homes built prior to 1960 may be filed on microfiche, and, if outside a subdivision, the name of the original owner may be required. An original owner's name can be found among the Land Records at the County Courthouse. Allow two weeks for the "as built" drawing.
- **Categories:** To confirm service area category, contact the **Montgomery County Department of Environmental Protection ("DEP") Watershed Management Division**, Alan Soukop at 240-777-7716 or alan.soukop@co.mo.md.us or fax request to 240-777-7715.

©2010, The Greater Capital Area Association of REALTORS®, Inc.

This recommended form is the property of the Greater Capital Area Association of REALTORS®, Inc. and is for use by members only.
 Previous editions of this form should be destroyed.

A. **Water:** Is the Property connected to public water? Yes No
 If no, has it been approved for connection to public water? Yes No Do not know
 If not connected, the source of potable water, if any, for the Property is: _____

B. **Sewer:** Is the Property connected to public sewer system? Yes No
 If no, answer the following questions:
 1. Has it been approved for connection to public sewer? Yes No Do not know
 2. Has an individual sewage disposal system been constructed on Property? Yes No
 Has one been approved for construction? Yes No
 Has one been disapproved for construction? Yes No Do not know.
 If no, explain: _____

C. **Categories:** The water and sewer service area category or categories that currently apply to the Property is/are (if known) _____. This category affects the availability of water and sewer service as follows (if known) _____.

D. **Recommendations and Pending Amendments (if known):**
 1. The applicable master plan contains the following recommendations regarding water and sewer service to the Property: _____
 2. The status of any pending water and sewer comprehensive plan amendments or service area category changes that would apply to the Property: _____

E. **Well and Individual Sewage System:** When a Buyer of real property that is located in a subdivision on which an individual sewage disposal system has been or will be installed receives the copy of the recorded subdivision plat, the Buyer must confirm in writing by signing said Plat that the Buyer has received and reviewed the Plat, including any restrictions on the location of initial and reserve wells, individual sewage disposal systems, and the buildings to be served by any individual sewage disposal system. By signing below, the Buyer acknowledges that, prior to signing the Contract, the Seller has provided the information referenced above, or has informed the Buyer that the Seller does not know the information referenced above; the Buyer further understands that, to stay informed of future changes in County and municipal water and sewer plans, the Buyer should consult the County Planning Board or any appropriate municipal planning or water and sewer agency.

Buyer _____	Date _____	Buyer _____	Date _____
-------------	------------	-------------	------------

2. DEFERRED WATER AND SEWER ASSESSMENT:

A. **Private Utility Company:** Are there any annual or semi-annual assessments paid to private companies that provided or financed utility installation? Yes No. If yes, the Buyer agrees to assume the future obligations and pay future annual assessments in the amount of \$ _____ for remaining years to _____ (name of company).

B. **Washington Suburban Sanitary Commission (WSSC) or Local Jurisdiction:**
 Are there any deferred water and sewer charges for which the Buyer may become liable which do not appear on the attached property tax bill? Yes No. If yes, the Buyer agrees to assume the future obligations and pay future annual assessments in the amount of \$ ~~450 a year for 23 YCS~~, or Buyer is hereby advised that a schedule of charges has not yet been established by the water and sewer authority, or a local jurisdiction has adopted a plan to benefit the property in the future. (Check applicable box).

Buyer acknowledges that there may be annual water and sewer charges which are not recorded in the land records and which may not be discovered by a diligent title search. Buyer's acknowledgement is not a waiver of the Seller's obligation to accurately disclose the existence of an assessment as set forth herein. Buyer's acknowledgment _____ (initials)

3. HOMEOWNER'S ASSOCIATION, CONDOMINIUM ASSOCIATION OR COOPERATIVE ASSOCIATION ASSESSMENTS: (Check all that apply) The Property is located in a not applicable Homeowners Association with mandatory fees (HOA), and/or Condominium Association and/or Cooperative or Other _____

©2010, The Greater Capital Area Association of REALTORS®, Inc.
 This recommended form is the property of the Greater Capital Area Association of REALTORS®, Inc. and is for use by members only.
 Previous editions of this form should be destroyed.

Complete the following for all boxes checked above:

Name of Project/Subdivision: _____
Management Company: _____ Telephone: _____
Regular Periodic Fee: \$ _____ per _____ . Special Assessments: \$ _____

Name of Project/Subdivision: _____
Management Company: _____ Telephone: _____
Regular Periodic Fee: \$ _____ per _____ . Special Assessments: \$ _____

Are there any assessments or fees approved yet not assessed? Yes No. If yes, amount \$ _____ and explain reason for assessment: _____

4. SPECIAL PROTECTION AREAS (SPA):

Refer to <http://www.montgomeryplanning.org/environment/SPA/faq.shtm> for an explanation of the "SPA" legislation and a map detailing protected areas. To determine if a particular property (which is located close to protected areas as designated on this map) is located within the boundaries of a "SPA" contact: spa@mncppc-mc.org, or call 301-495-4540.

<p>Is this Property located in an area designated as a Special Protection Area? <input type="checkbox"/> Yes <input checked="" type="checkbox"/> No. If yes, special water quality measures and certain restrictions on land uses and impervious surfaces may apply. Under Montgomery County law, Special Protection Area (SPA) means a geographic area where:</p> <p>A. Existing water resources, or other environmental features directly relating to those water resources, are of high quality or are unusually sensitive;</p> <p>B. Proposed land uses would threaten the quality or preservation of those resources or features in the absence of special water quality protection measures which are closely coordinated with appropriate land use controls.</p> <p>An SPA may be designated in:</p> <p>(1) a land use plan;</p> <p>(2) the Comprehensive Water Supply and Sewer System Plan;</p> <p>(3) a watershed plan; or</p> <p>(4) a resolution adopted after at least fifteen (15) days' notice and a public hearing.</p> <p>The Buyer acknowledges by signing this disclosure that the Seller has disclosed to the Buyer the information contained in Sections A and B before Buyer executed a contract for the above-referenced Property. Further information is available from the staff and website of Maryland-National Capital Area Park and Planning Commission (M-NCPPC).</p>
<p>_____ Buyer</p>
<p>_____ Buyer</p>

5. PROPERTY TAXES:

Each property in Montgomery County, MD is assessed for annual real property taxes based on several different components. A copy of the tax bill will reflect which categories and components are applicable to this property, including, whether the property is located in a municipality, a special taxing district, a development district, a proposed development district, and/or whether this property is subject to a special area tax or any WSSC front foot benefit charges. Definitions and explanations of each of these categories can be obtained at the Montgomery County Department of Finance website in the "**Frequently Asked Questions**" section located at: www.montgomerycountymd.gov/apps/tax/index.asp and select "FAQ". Additional information relating to taxes and the assessment and appeal process can be located at www.dat.state.md.us/sdatweb/taxassess.html - this provides tax information from the State of Maryland.

IN ACCORDANCE WITH MONTGOMERY COUNTY CODE SECTION 14-17, THE SELLER(S) MUST ATTACH HERETO A COPY OF THE CURRENT REAL PROPERTY TAX BILL FOR THIS PROPERTY. A current copy of the tax bill for this property can be obtained at: www.montgomerycountymd.gov/apps/tax/index.asp

©2010, The Greater Capital Area Association of REALTORS®, Inc.
This recommended form is the property of the Greater Capital Area Association of REALTORS®, Inc. and is for use by members only.
Previous editions of this form should be destroyed.

IN ADDITION, SELLER(S) ARE REQUIRED TO PROVIDE POTENTIAL BUYER'S WITH THE ESTIMATED PROPERTY TAX AND NON-TAX CHARGES FOR THE FIRST FULL FISCAL YEAR OF OWNERSHIP. Information relative to this estimate, including how it was calculated and its significance to Buyers can be obtained at www.montgomerycountymd.gov/estimatedtax. Buyer(s) hereby acknowledge receipt of 1) a copy of the current real property tax bill AND 2) the estimated property tax and non-tax charges in the Buyer's first full fiscal year of ownership, both as required by Montgomery County Code. Buyer's acknowledgment of receipt of both tax tax disclosures _____ (initials)

DEVELOPMENT DISTRICT DISCLOSURE - NOTICE OF SPECIAL TAX OR ASSESSMENT:

Buyer is hereby notified that a property can be located in an Existing Development District or a Proposed Development District as defined under Chapter 14 of the Montgomery County Code. A Development District is a special taxing district in which owners of properties pay an additional tax or assessment in order to pay for public improvements within the District. This property is located in a Development District in a proposed Development District not located in an existing or proposed Development District. Check as applicable.

If the property is located in an Existing or Proposed Development District, the following disclosure is given: Each year the buyer of this property must pay a special assessment or special tax imposed under Chapter 14 of the Montgomery County Code, in addition to all other taxes and assessments that are due. If this property is located in a Development District, then, as of the date of execution of this disclosure, the special assessment or special tax on this property amounts to \$ _____ each year. A map reflecting Existing Development Districts can be obtained at; http://www.montgomerycountymd.gov/apps/OCP/Tax/map/Existing_DevDistricts.pdf. If the property is located in a Proposed Development District the estimated maximum special assessment or special tax amounts to \$ _____ each year. A map reflecting Proposed Development Districts can be obtained at; http://www.montgomerycountymd.gov/apps/ocp/tax/map/dev_districts.pdf.

Typically, the Development District Special Tax will increase approximately 2% each July 1. For more information, please contact the Montgomery County Department of Finance at 240-777-8860. FAQ's regarding Development Districts can be viewed at <http://www.montgomerycountymd.gov/apps/OCP/Tax/FAQ.asp>.

6. TAX BENEFIT PROGRAMS:

The Property might currently be under a tax benefit program that has deferred taxes due on transfer or may require a legally binding commitment from Buyer to remain in the program, such as, but not limited to:

A. Forest Conservation and Management Program (FC&MP): Buyer is hereby notified that a property under a Maryland Forest Conservation Management Agreement (FCMA) could be subject to recapture/deferred taxes upon transfer. Is the Property under FCMA? Yes No. If yes, taxes assessed shall be paid by _____.

B. Agricultural Program: Is the Property subject to agricultural transfer taxes? Yes No. If yes, taxes assessed as a result of the transfer shall be paid by _____. Confirm if applicable to this property at; www.dat.state.md.us/sdatweb/agtransf.html

C. Other Tax Benefit Programs: Does the Seller have reduced property taxes from any government program? Yes No. If yes, explain: _____.

7. STORM WATER MANAGEMENT FEES – CITY OF TAKOMA PARK:

The City of Takoma Park, MD maintains its own storm water facilities and assesses and bills for an annual **storm water management fee** on all real property located in the city. This assessment is made separate from City property taxes and requires a separate inquiry as to applicability and the amount to be collected and/or prorated. Inquiries can be made at 301-891-7212. Is the property located in the City of Takoma Park and subject to this assessment? Yes No

8. RECORDED SUBDIVISION PLAT:

Plats are available at the [MNCPPC](http://www.mncppc.org) or at the Judicial Center, Room 218, 50 Maryland Avenue, Rockville, MD or at 240-777-9477. In order to obtain a plat you will be required to supply the Lot, Block, Section and Subdivision, as applicable, for the property. Plats are also available online at http://www.montgomeryplanning.org/info/plat_maps.shtm or at www.plats.net. Note: user id = **plato** and password = **plato#**.

©2010, The Greater Capital Area Association of REALTORS®, Inc.

This recommended form is the property of the Greater Capital Area Association of REALTORS®, Inc. and is for use by members only. Previous editions of this form should be destroyed.

If the property is an unimproved lot or a newly constructed house being sold for the first time, the Buyer shall be provided a copy of the recorded subdivision plat prior to entering into a contract. Buyer hereby acknowledges receipt of a copy of the recorded subdivision plat. **Buyer's initials:** _____

However, if the property is **not** an unimproved lot or a newly constructed house (i.e. resale), the Buyer may, in writing, waive receipt of a copy of such plat at the time of execution of the contract, but shall, prior to or at the time of settlement, be provided with a copy of the subdivision plat. The subdivision plat is not intended as a substitute for examination of title and does not show every restriction and easement.

Buyer hereby acknowledges receipt of a copy of the recorded subdivision plat. **Buyer's initials:** _____

OR

Buyer hereby waives receipt of a copy of such plat at time of execution of contract, but shall, prior to or at the time of settlement, be provided a copy of the subdivision plat. **Buyer's initials:** _____

9. AGE OF HOME AND FEDERAL LEAD BASED PAINT: Title X, Section 1018, the Residential Lead-Based Paint Hazard Act of 1992 (the Act), requires the disclosure of certain information regarding lead-based paint and lead-based paint hazards in connection with the sale of residential real property. Unless otherwise exempt, the Act applies only to housing constructed prior to 1978. A Seller of pre-1978 housing is required to disclose to the Buyer, based upon the Seller's actual knowledge, all known lead-based paint hazards in the Property and provide the Buyer with any available reports in the Seller's possession relating to lead-based paint or lead-based paint hazards applicable to the Property. The Seller, however, is not required to conduct or pay for any lead-based paint risk assessment or inspection.

At the time that the offer to purchase is entered into by the Buyer, the Seller is required to provide the Buyer with the EPA pamphlet entitled "Protect Your Family From Lead In Your Home" and a "Disclosure of Information on Lead-Based Paint and Lead-Based Paint Hazards" form (GCAAR #500). The Seller is required under the Act to provide the Buyer with a ten (10) day time period (or other mutually agreeable time period) for the Buyer, at the Buyer's expense, to conduct a risk assessment or inspection for the presence of lead-based paint and/or lead-based paint hazards unless the Buyer waives such assessment or inspection by indicating such waiver on the Lead-Based Paint Disclosure form. Seller and any agent involved in the transaction are required to retain a copy of the completed Lead-Based Paint Disclosure form for a period of three (3) years following the date of the settlement.

A SELLER WHO FAILS TO GIVE THE REQUIRED LEAD-BASED PAINT DISCLOSURE FORM AND EPA PAMPHLET MAY BE LIABLE UNDER THE ACT FOR THREE TIMES THE AMOUNT OF DAMAGES AND MAY BE SUBJECT TO BOTH CIVIL AND CRIMINAL PENALTIES.

Seller represents and warrants to Buyer, broker(s), broker(s)' agents and subagents, intending that they rely upon such warranty and representation, that the property: **(Seller to initial applicable line):** _____ was constructed prior to 1978 OR DM _____ was not constructed prior to 1978 OR _____ the date of construction is uncertain. If the Property was constructed prior to 1978 or if the date of construction is uncertain, as indicated by Seller's initial above, Seller and Buyer mutually agree that the requirements of the Act shall apply to the sale of the Property. Seller and Buyer acknowledge that the real estate brokers and salespersons involved in the sale of the Property have no duty to ascertain or verify the date of construction and assume no such duty or responsibility. Seller and Buyer agree, represent and warrant, each unto the other, that no binding and enforceable contract shall be deemed to exist or to have been formed unless the requirements of the Act have been complied with prior to the execution of this Contract by Seller and Buyer. Seller and Buyer represent and warrant that each intended, as a material term of the offer and acceptance that the requirements of the Act be complied with as an express condition of the formation of a binding and enforceable contract by and between the parties. Buyer and Seller acknowledge by their respective initials below that they have read and understand the provisions of this Paragraph 9.

DM
Seller's Initials

Buyer's Initials

10. DISCLOSURE/DISCLAIMER STATEMENT: A property owner may be exempt from Maryland Residential Property Disclosure Act as defined in the Maryland Residential Property Disclosure and Disclaimer Statement. Is Seller exempt from the Maryland Residential Property Disclosure Act? Yes No. If no, see attached Maryland Residential Disclosure and Disclaimer Statement. If yes, reason for exemption: NEW HOME

©2010, The Greater Capital Area Association of REALTORS®, Inc.

This recommended form is the property of the Greater Capital Area Association of REALTORS®, Inc. and is for use by members only.

Previous editions of this form should be destroyed.

11. SMOKE DETECTORS: Pursuant to Montgomery County Code, the Seller is required to have working smoke detectors on all levels with bedrooms. In addition, Maryland law requires the following disclosure: **This residential dwelling unit contains alternating current (AC) electric service. In the event of a power outage, an alternating current (AC) powered smoke detector will not provide an alarm. Therefore, the Buyer should obtain a dual-powered smoke detector or a battery-powered smoke detector.** Does this Property have either a dual-powered smoke detector or a battery-powered smoke detector?

Yes No Unknown

Certain municipalities have requirements exceeding those of Montgomery County; see municipality website for additional disclosures.

12. HISTORIC PRESERVATION:

Check questionable properties' status with the **Montgomery County Historic Preservation Commission** (301-563-3400) or go to <http://www.montgomeryplanning.org/historic/index.shtm> to check applicability. Potential Buyers of property located in the **City of Rockville** should be advised that structures that are 50 years old or older, or which may be otherwise significant according to criteria established by the Rockville Historic District Commission, should be notified prior to purchase that demolition and building permit applications for substantial alteration will trigger an evaluation and approval process. This process may result in the property being designated a historic site, and if so, any exterior alterations must be reviewed and approved.

Has the Property been designated as an historic site in the master plan for historic preservation? Yes No.

Is the Property located in an area designated as an historic district in that plan? Yes No.

Is the Property listed as an historic resource on the County location atlas of historic sites? Yes No.

Seller has provided the information required of Sec 40-12A as stated above, and the Buyer understands that special restrictions on land uses and physical changes may apply to this property. To confirm the applicability of this County Code (Sec 40-12A) and the restrictions on land uses and physical changes that may apply, contact the staff of the County Historic Preservation Commission, 301-563-3400. If the property is located within a local municipality, contact the local government to verify whether the property is subject to any additional local ordinances.

Buyer

Buyer

13. MARYLAND FOREST CONSERVATION LAWS:

A. Forest Conservation Law: The Buyer is notified that the cutting, clearing, and grading of more than 5,000 square feet of forest or any champion tree on the Property is subject to the requirements of the **Forest Conservation Law**. The Buyer is required to comply with the **Forest Conservation Law, Chapter 22A of the Montgomery County Code**. In order to assure compliance with the law, the Buyer is notified of the need to contact the **Countywide Environmental Planning Division** of the Maryland-National Capital Park and Planning Commission (**M-NCPPC**), whether it means obtaining a written exemption from the Forest Conservation Laws from **M-NCPPC** or obtaining approval of a Natural Resource Inventory/Forest Stand Delineation Plan, Forest Conservation Plan, or Tree Save Plan prior to cutting, clearing, and grading of more than 5,000 square feet of forest, obtaining a grading or sediment control permit, or developing the Property. Further, Seller represents and warrants that no activities have been undertaken on the Property in violation of the Forest Conservation Law and that if such activities have occurred in violation of the applicable law, that Seller has paid all of the penalties imposed and taken all of the corrective measures requested by **M-NCPPC**.

B. Forest Conservation Easements: Seller represents and warrants that the Property is is not currently subject to a recorded Category I or Category II Forest Conservation Easement, Management Agreement or an approved Forest Conservation Plan, Tree Save Plan, or any other plan requiring the protection of natural areas, or any other pending obligation binding the owner of the Property under Forest Conservation Law requirements. If the Property is encumbered by any such easement or plan, attach a copy of the plat or recorded document (if available).

14. MODERATELY-PRICED DWELLING UNIT: Is the Property part of the Moderately-Priced Dwelling Unit Program in Montgomery County? Yes No. In City of Rockville? Yes No. If yes to either question, Seller to indicate month and year of initial offering: _____. If initial offering is after March 20, 1989, the prospective Buyer and Seller should contact the appropriate jurisdictional agency to ascertain the legal buying and selling restrictions on the Property.

©2010, The Greater Capital Area Association of REALTORS®, Inc.

This recommended form is the property of the Greater Capital Area Association of REALTORS®, Inc. and is for use by members only.

Previous editions of this form should be destroyed.

15. UNDERGROUND STORAGE TANK: For information regarding Underground Storage Tanks and the procedures for their removal or abandonment, contact the Maryland Department of the Environment. www.mde.state.md.us

Does the Property contain an unused underground storage tank?

Yes No Unknown. If yes, explain when, where and how it was abandoned: _____

16. TAKOMA PARK RENTAL HOUSING LAWS: The sale of any residential rental property located within the city limits of Takoma Park must contain a notice concerning the city's rental laws along with copies of certain rent reports and rental licensing inspection reports. GCAAR Form #1357 recites the applicable laws and identifies the reports that must be attached. This property is is not subject to the Takoma Park Rental Housing Law Notice requirements.

17. AGRICULTURAL ZONE DISCLOSURE NOTICE: Sellers of Montgomery County properties that are located in, adjoin or confront an area that is zoned agricultural must make certain disclosures to potential Buyers. These disclosures are contained in GCAAR Form #1361, which must be provided to potential Buyers prior to entering into a Contract for the purchase and sale of a property that is subject to this Agricultural Zone Disclosure requirement. Additional information can be obtained at http://www.mcmaps.org/notification/agricultural_lands.aspx. This property is is not subject to the Agricultural Zone Disclosure Notice requirements.

18. NOTICE CONCERNING CONSERVATION EASEMENTS: If the Property is encumbered by a Conservation Easement as defined in Section 10-705 of the Real Property Article, Annotated Code of Maryland, the contract must contain a notice concerning the easement, which is contained in an attached addendum. This Paragraph does not apply to the sale of property in an action to foreclose a mortgage or deed of trust. (If the Property is encumbered by a Conservation Easement: See Conservation Easement Addendum GCAAR Form #1359). This property is is not subject to a Conservation Easement.

19. GROUND RENT: If the Property is subject to ground rent and the ground rent is not timely paid, the ground lease holder (i.e., the person to whom the ground rent is payable) may bring an action under Section 8-402.3 of the Real Property Article, Annotated Code of Maryland. As a result of this action, a lien may be placed upon the property. If the Property is subject to ground rent, Sections 14-116 and 14-116.1 of the Real Property Article provide the purchaser, upon obtaining ownership of the Property, with certain rights and responsibilities relative to the ground rent. (If the Property is subject to ground rent: See Property Subject to Ground Rent Addendum, GCAAR Form #1360.) This property is is not subject to Ground Rent.

20. AIRPORTS AND HELIPORTS: The following list of airports and heliports includes those in Montgomery County and the surrounding area that may be within a five-mile radius of the Property. This list was compiled from data provided by the Washington Airports District Office of the Federal Aviation Administration and was current as of 4/1/07. Buyer should be aware of the fact that most properties in Montgomery County are within five (5) miles of an airport or heliport installation. Refer to the FAA website for a current list. http://www.faa.gov/airports/airport_safety/airportdata_5010.

Montgomery County

- Bethesda Naval Medical Hospital Heliport, 8901 Rockville Pike, Bethesda, MD 20889
- Davis Airport, 7200 Hawkins Creamery Road, Laytonsville, MD 20879
- Dow Jones & Company, Inc., 11501 Columbia Pike, Silver Spring, MD 20904
- Federal Support Center Heliport, 5321 Riggs Road, Gaithersburg, MD 20882
- Flying M Farms, 24701 Old Hundred Road, Comus, MD 20842
- IBM Corporation Heliport, 18100 Frederick Avenue, Gaithersburg, MD 20879
- Maryland State Police Heliport, 16501 Norwood Road, Sandy Spring, MD 20860
- Montgomery County Airpark, 7940 Airpark Road, Gaithersburg, MD 20879
- Shady Grove Adventist Hospital, 9901 Medical Center Drive, Rockville, MD 20850
- Suburban Hospital, 8600 Old Georgetown Road, Bethesda, MD 20814
- Waredaca Farm, 4015 Damascus Road, Gaithersburg, MD 20760
- Washington Adventist Hospital, 7600 Carroll Avenue, Takoma Park, MD 20912

©2010, The Greater Capital Area Association of REALTORS®, Inc.

This recommended form is the property of the Greater Capital Area Association of REALTORS®, Inc. and is for use by members only.

Previous editions of this form should be destroyed.

Prince George's County

Citizens Bank Helipad, 14401 Sweitzer Lane, Laurel, MD 20707
College Park, 1909 Cpl Frank Scott Drive, College Park, MD 20740
The Greater Laurel Beltsville Hospital, 7100 Contee Road, Laurel, MD 20707

Frederick County

Faux-Burhams Airport, 9401 Ball Road, Ijamsville, MD 21754
Ijamsville Airport, 9701 C. Reichs Ford Road, Ijamsville, MD 21754
Stol-Crest Airfield, 3851 Price's Distillery Road, Urbana, MD 21754

Carroll County

Walters Airport, 7017 Watersville Road, Mt. Airy, MD 21771

District of Columbia

Children's National Medical Center, 111 Michigan Avenue, NW, 20010
Georgetown University Hospital, 3800 Reservoir Road, NW, 20007
Metropolitan Police, Dist. 2, 3320 Idaho Avenue, NW, 20007
Metropolitan Police, Dist. 3, 1620 V Street, NW, 20007
Michael R. Nash, 50 Florida Avenue, NE 20002
National Presbyterian Church, 4101 Nebraska Avenue, NW, 20016
Ronald Reagan Washington National Airport, Arlington County 20001
Sibley Memorial Hospital, 5255 Loughboro Road, NW, 20016
Steuart Office Pad, Steuart Petroleum Co., 4640 40th Street, NW, 20016
Walter Reed Hospital, 6825 16th Street, NW, 20012
Washington Hospital Center, 110 Irving Street, NW, 20010
Washington Post, 1150 15th Street, NW, 20017

Virginia

Leesburg Executive, 1001 Sycolin Road, Leesburg, 22075
Loudoun Hospital Center, 224 Cornwall, NW, Leesburg, 22075
Ronald Reagan Washington National Airport, Arlington County 20001

21. ENERGY EFFICIENCY DISCLOSURE NOTICE: Before signing a contract for the sale of a single-family home, Sellers of Montgomery County properties must provide Buyers with:

A. Information about home energy efficiency improvements, including the benefit of conducting a home energy audit. Buyers should visit the following websites for this information:

- http://gcaar.com/news_ektid5454.aspx
- www.Energystar.gov/homeperformance
- www.Lighterfootstep.com
- www.Goinggreenathome.org

B. Copies of electric, gas and home heating oil bills **OR** cost and usage history for the single-family home for the immediate prior 12 months, unless the single-family home was unoccupied for the entire prior 12 months.

Has the home been owner-occupied for the immediate prior 12 months? Yes No. **If No, the seller must provide the buyer with the required information for that part of the prior 12 months, if any, that the seller occupied the single-family home. Sellers may use GCAAR Form #932 to disclose the utility costs and usage history.**

Buyer acknowledges that they have been provided with the information as stated in A and B above. Buyer's acknowledgment _____ (initials)

©2010, The Greater Capital Area Association of REALTORS®, Inc.

This recommended form is the property of the Greater Capital Area Association of REALTORS®, Inc. and is for use by members only. Previous editions of this form should be destroyed.

22. **HEADINGS:** The Paragraph headings of this Agreement are for convenience and reference only, and in no way define or limit the intent, rights or obligations of the parties.

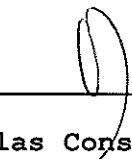

Seller
Douglas Construction Group, LL
Date 8/13/2010

Seller
Date

Buyer
Date

Buyer
Date

©2010, The Greater Capital Area Association of REALTORS®, Inc.

This recommended form is the property of the Greater Capital Area Association of REALTORS®, Inc. and is for use by members only.
Previous editions of this form should be destroyed.

GCAAR # 900 - REA Disclosure
(Previously form # 1302)

Page 9 of 9

1/2010



STATE OF MARYLAND
REAL ESTATE COMMISSION

Understanding Whom Real Estate Agents Represent

Before you decide to sell or buy or rent a home you need to consider the following information:

Agents Who Represent the Seller

Seller's Agent: A seller's agent works for the real estate company that lists and markets the property for the sellers or landlords, and exclusively represents the sellers or landlords. That means that he or she may assist the buyer or tenant in purchasing or renting the property, but his or her duty of loyalty is only to the sellers or landlords. The seller pays the seller's agent's fees as specified in a written listing agreement.

Cooperating Agent: A cooperating agent works for a real estate company different from the company for which the seller's agent works. The cooperating agent can assist a buyer or tenant in purchasing or renting a property, but his or her duty of loyalty is only to the sellers or landlords. The cooperating agent's fee is paid by the sellers or landlords through the seller's agent's company.

Agents Who Represent the Buyer

Presumed Buyer's Agent (no written agreement): When a person goes to a real estate agent for assistance in finding a home to buy or rent, the agent is presumed to be representing the buyer and can show the buyer properties that are *not* listed by the agent's real estate company. A presumed buyer's agent may *not* make or prepare an offer or negotiate a sale for the buyer. The buyer does *not* have an obligation to pay anything to the presumed agent.

If for any reason the buyer does not want the agent to represent him or her as a presumed agent, either *initially* or *at any time*, the buyer can decline or terminate a presumed agency relationship simply by saying so.

Buyer's Agent (by written agreement): A buyer or tenant may enter into a written contract with a real estate agent which provides that the agent will represent the buyer or tenant in locating a property to buy or rent. The agent is then known as the buyer's agent. That agent assists the buyer in evaluating properties and preparing offers, and negotiates in the best interests of the buyer or tenant. The agent's fee is paid according to the written agreement between the agent and the buyer or tenant. If you as a buyer or tenant wish to have an agent represent you exclusively, you must enter into a written buyer agency agreement.

Dual Agents

The possibility of **dual agency** arises when the buyer's agent and the seller's agent both work for the same real estate company, and the buyer is interested in property listed by that company. The real estate company, or broker, is called the "dual agent". Dual agents do not act exclusively in the interests of either the seller or buyer, or landlord or tenant, and therefore cannot give undivided loyalty to either party. There may be a conflict of interest because the interests of the seller and buyer may be different or adverse.

If both seller and buyer, or landlord and tenant, agree to dual agency by signing a Consent For Dual Agency form, then the real estate company (the "dual agent") will assign one agent to represent the seller or landlord (the seller's "intra-company agent") and another agent to represent the buyer or tenant (the buyer's "intra-company agent"). Intra-company agents may provide the same services to their clients as exclusive seller's or buyer's agents, including advising their clients as to price and negotiation strategy, provided the clients have both consented to be represented by dual agency.

If either party does not agree to dual agency, the real estate company may withdraw the agency agreement for that particular property with either the buyer or seller, or both. If the seller's agreement is terminated, the seller must then either represent him or herself or arrange to be represented by an agent from another real estate company. If the buyer's agreement is terminated, the buyer or tenant may choose to enter into a written buyer agency agreement with an agent from a different company. Alternatively, the buyer or tenant may choose not to be represented by an agent of his or her own but simply to receive assistance from the seller's agent, from another agent in that company, or from a cooperating agent from another company.

No matter what type of agent you choose to work with, you have the following rights and responsibilities in selling or buying or renting property:

>Real estate agents are obligated by law to treat all parties to a real estate transaction honestly and fairly. They must exercise reasonable care and diligence and maintain the confidentiality of clients. They must not discriminate in the offering of properties; they must promptly present each written offer or counteroffer to the other party; and they must answer questions truthfully.

>Real estate agents must disclose all material facts that they know or should know relating to a property. An agent's duty to maintain confidentiality does not apply to the disclosure of material facts about a property.

>All agreements with real estate agents should be in writing and should explain the duties and obligations of the agent. The agreement should explain how the agent will be paid and any fee-sharing agreements with other agents.

>You have the responsibility to protect your own interests. You should carefully read all agreements to make sure they accurately reflect your understanding. A real estate agent is qualified to advise you on real estate matters only. If you need legal or tax advice, it is your responsibility to consult a licensed attorney or accountant.

Any complaints about a real estate agent may be filed with the Real Estate Commission at 500 North Calvert Street, Baltimore, MD 21202. (410) 230-6200.

This notice is information required by law and is NOT A CONTRACT

We, the Sellers/Landlord Buyers/Tenants acknowledge receipt of a copy of this disclosure and

that RE/MAX Realty Services (firm name)

And Jeremy Lichtenstein (salesperson) are working as:

- Seller/landlord's agent
- Cooperating agent
- Buyer's agent
- Dual agent (See Consent for Dual Agency form)
(you may check more than one box)

Signature [Signature] Date 8/13/2010 Signature _____ Date _____

I certify that on this date I made the required agency disclosure to the individuals identified below and they were unable or unwilling to acknowledge receipt of a copy of this disclosure statement.

Signature of agent [Signature] Date 8/13/2010

Name of individual to whom disclosure was made _____

Name of individual to whom disclosure was made _____



STATE OF MARYLAND
REAL ESTATE COMMISSION

Consent for Dual Agency

(in this form, the word "seller" includes "landlord", "buyer" includes "tenant", and "purchase" or "sale" includes "lease.")

When Dual Agency May Occur

The possibility of dual agency arises when:

- >The buyer is interested in a property listed by a real estate company; and
- >The seller's agent and the buyer's agent work for that same real estate company.

Before the buyer and seller can proceed to be represented by a dual agent, they must both sign a Consent for Dual Agency. If they have previously signed a Consent for Dual Agency, they must affirm their consent for the sale of a particular property to a particular buyer.

Your Choices Concerning Dual Agency

When a dual agency situation in fact arises, the buyer and seller have the following options:

Consent in writing to dual agency. If all parties consent in writing, the real estate company (the "dual agent") will assign one real estate agent from the company to represent the seller or landlord (the seller's "intra-company agent") and another agent from the company to represent the buyer or tenant (the buyer's "intra-company agent"). Intra-company agents may provide the same services to their clients as an exclusive seller's or buyer's agent, including advising their clients as to price and negotiation strategy.

Do not consent to dual agency. If either the buyer or the seller, or landlord or tenant, refuses to consent in writing to dual agency, the real estate company must terminate the agency agreement for that particular property with either the buyer or the seller, or both. If the seller's agreement is terminated, the seller must then either represent him or herself or arrange to be represented by an agent from another real estate company. If the buyer's agreement is terminated, the buyer or tenant may choose to enter into a written buyer agency agreement with an agent from a different company. Alternatively, the buyer or tenant may choose not to be represented by an agent of his or her own but simply to receive assistance from the seller's agent, from another agent in that company, or from a cooperating agent from another company.

Important Considerations Before Making a Decision About Dual Agency

~~A~~ dual agent does not exclusively represent either the seller or buyer and there may be a conflict of interest because the interests of the seller and buyer may be different or adverse.

~~A~~ s a dual agent, the real estate company does not owe undivided loyalty to either the seller or buyer.

Duties of a Dual Agent and Intra-Company Agent

Like other agents, dual agents and intra-company agents must keep confidential information about a client's bargaining position or motivations unless the client gives consent to disclose the information. For example, a dual agent or intra-company agent may not tell the other party, or the other party's agent, without consent of the client:

- >anything the client asks to be kept confidential*,
- >that the seller would accept a lower price or other terms,
- >that the buyer would accept a higher price or other terms,
- >the reasons why a party wants to sell or buy, or
- >that a party needs to sell or buy quickly.

*However, like all agents, a dual agent and intra-company agent must disclose any material facts about a property to the other party.

How Dual Agents Are Paid

Only the dual agent receives compensation on the sale of a property listed by that company.

If the financial bonus is offered to an agent who sells property that is listed with his company, this fact must be disclosed in writing to both the buyer and seller.

I have read the above information, and I understand the terms of the dual agency. I understand that I do not have to consent to a dual agency, and that if I do not consent, there will not be a dual agency. I hereby voluntarily consent to have

RE/MAX Realty Services act as dual agent for me as the:

(Firm Name)

seller in the sale of the property at: 5813 Ipswich Rd

buyer in the purchase of any property listed for sale with the above-referenced firm.

Signature	Date	Signature	Date
-----------	------	-----------	------

AFFIRMATION

The undersigned Seller(s) hereby affirms consent to Dual Agency:

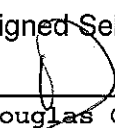
 8/13/2011 _____
Signature Douglas Construction Group, LL Date Signature Date

The undersigned Buyer(s) hereby affirms consent to dual agency:

Signature Date 5813 Ipswich Rd
Property Location

Signature Date

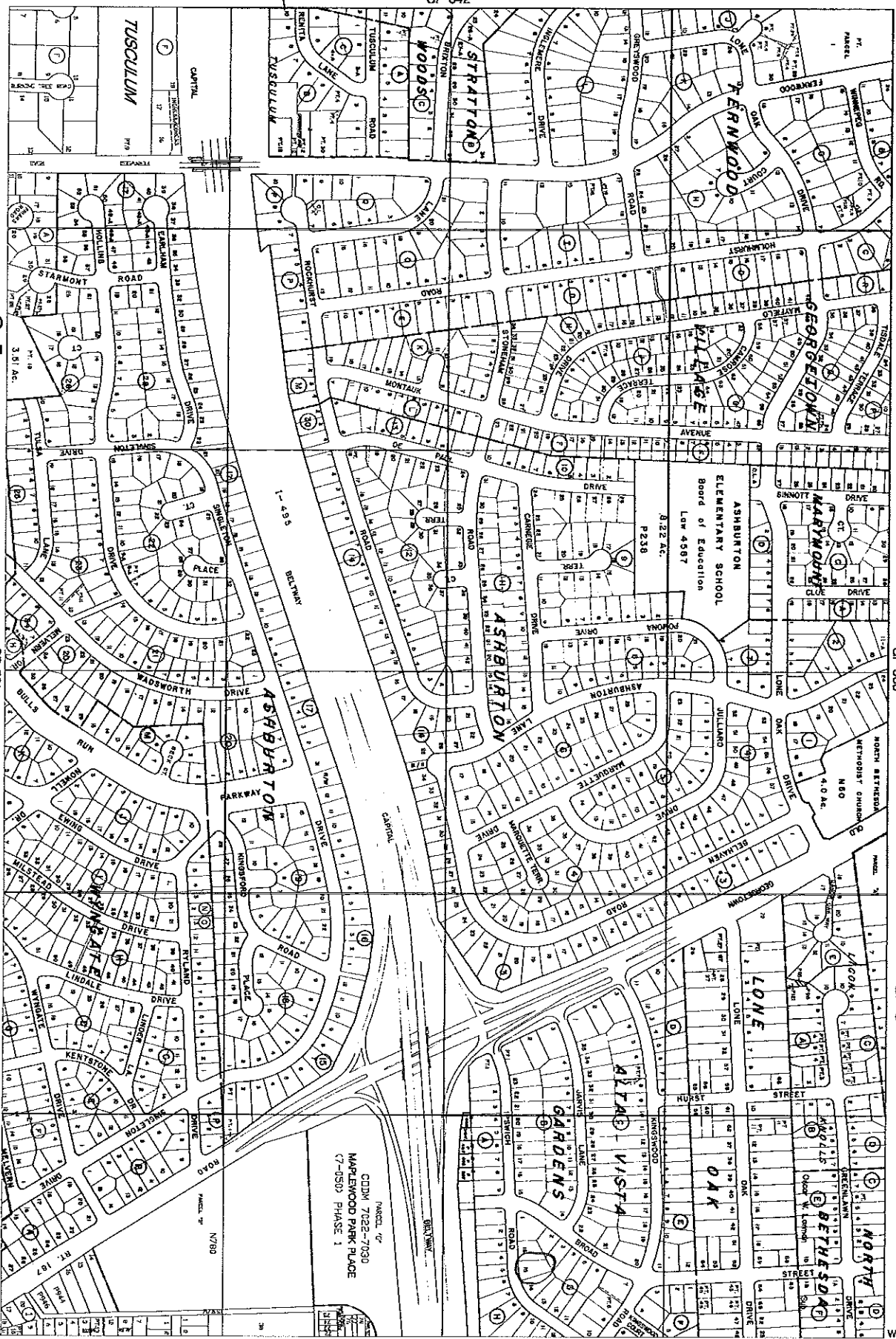

P 2
GP 342

N4400

G 5

G 5

GP 562

GP 561

G 6

G 6

N4800

HP 122
P 2

THIS MAP WAS PREPARED BY COPYRIGHT, THEIR NAME NOT BE COMED
OR REPRODUCED IN ANY FORM INCLUDING ELECTRONIC MEANS SUCH AS
PHOTOCOPYING, RECORDING, OR BY ANY INFORMATION STORAGE AND
RETRIEVAL SYSTEM WITHOUT THE WRITTEN PERMISSION OF THE
MONTGOMERY COUNTY DEPARTMENT OF PLANNING.



DATE	BY	REVISION
10/15/03	MDP	INITIAL DESIGN
11/10/03	MDP	REVISED DESIGN
12/15/03	MDP	FINAL DESIGN
01/15/04	MDP	FINAL DESIGN
02/15/04	MDP	FINAL DESIGN
03/15/04	MDP	FINAL DESIGN
04/15/04	MDP	FINAL DESIGN
05/15/04	MDP	FINAL DESIGN
06/15/04	MDP	FINAL DESIGN
07/15/04	MDP	FINAL DESIGN
08/15/04	MDP	FINAL DESIGN
09/15/04	MDP	FINAL DESIGN
10/15/04	MDP	FINAL DESIGN
11/15/04	MDP	FINAL DESIGN
12/15/04	MDP	FINAL DESIGN
01/15/05	MDP	FINAL DESIGN
02/15/05	MDP	FINAL DESIGN
03/15/05	MDP	FINAL DESIGN
04/15/05	MDP	FINAL DESIGN
05/15/05	MDP	FINAL DESIGN
06/15/05	MDP	FINAL DESIGN
07/15/05	MDP	FINAL DESIGN
08/15/05	MDP	FINAL DESIGN
09/15/05	MDP	FINAL DESIGN
10/15/05	MDP	FINAL DESIGN
11/15/05	MDP	FINAL DESIGN
12/15/05	MDP	FINAL DESIGN
01/15/06	MDP	FINAL DESIGN
02/15/06	MDP	FINAL DESIGN
03/15/06	MDP	FINAL DESIGN
04/15/06	MDP	FINAL DESIGN
05/15/06	MDP	FINAL DESIGN
06/15/06	MDP	FINAL DESIGN
07/15/06	MDP	FINAL DESIGN
08/15/06	MDP	FINAL DESIGN
09/15/06	MDP	FINAL DESIGN
10/15/06	MDP	FINAL DESIGN
11/15/06	MDP	FINAL DESIGN
12/15/06	MDP	FINAL DESIGN
01/15/07	MDP	FINAL DESIGN
02/15/07	MDP	FINAL DESIGN
03/15/07	MDP	FINAL DESIGN
04/15/07	MDP	FINAL DESIGN
05/15/07	MDP	FINAL DESIGN
06/15/07	MDP	FINAL DESIGN
07/15/07	MDP	FINAL DESIGN
08/15/07	MDP	FINAL DESIGN
09/15/07	MDP	FINAL DESIGN
10/15/07	MDP	FINAL DESIGN
11/15/07	MDP	FINAL DESIGN
12/15/07	MDP	FINAL DESIGN
01/15/08	MDP	FINAL DESIGN
02/15/08	MDP	FINAL DESIGN
03/15/08	MDP	FINAL DESIGN
04/15/08	MDP	FINAL DESIGN
05/15/08	MDP	FINAL DESIGN
06/15/08	MDP	FINAL DESIGN
07/15/08	MDP	FINAL DESIGN
08/15/08	MDP	FINAL DESIGN
09/15/08	MDP	FINAL DESIGN
10/15/08	MDP	FINAL DESIGN
11/15/08	MDP	FINAL DESIGN
12/15/08	MDP	FINAL DESIGN
01/15/09	MDP	FINAL DESIGN
02/15/09	MDP	FINAL DESIGN
03/15/09	MDP	FINAL DESIGN
04/15/09	MDP	FINAL DESIGN
05/15/09	MDP	FINAL DESIGN
06/15/09	MDP	FINAL DESIGN
07/15/09	MDP	FINAL DESIGN
08/15/09	MDP	FINAL DESIGN
09/15/09	MDP	FINAL DESIGN
10/15/09	MDP	FINAL DESIGN
11/15/09	MDP	FINAL DESIGN
12/15/09	MDP	FINAL DESIGN
01/15/10	MDP	FINAL DESIGN
02/15/10	MDP	FINAL DESIGN
03/15/10	MDP	FINAL DESIGN
04/15/10	MDP	FINAL DESIGN
05/15/10	MDP	FINAL DESIGN
06/15/10	MDP	FINAL DESIGN
07/15/10	MDP	FINAL DESIGN
08/15/10	MDP	FINAL DESIGN
09/15/10	MDP	FINAL DESIGN
10/15/10	MDP	FINAL DESIGN
11/15/10	MDP	FINAL DESIGN
12/15/10	MDP	FINAL DESIGN
01/15/11	MDP	FINAL DESIGN
02/15/11	MDP	FINAL DESIGN
03/15/11	MDP	FINAL DESIGN
04/15/11	MDP	FINAL DESIGN
05/15/11	MDP	FINAL DESIGN
06/15/11	MDP	FINAL DESIGN
07/15/11	MDP	FINAL DESIGN
08/15/11	MDP	FINAL DESIGN
09/15/11	MDP	FINAL DESIGN
10/15/11	MDP	FINAL DESIGN
11/15/11	MDP	FINAL DESIGN
12/15/11	MDP	FINAL DESIGN
01/15/12	MDP	FINAL DESIGN
02/15/12	MDP	FINAL DESIGN
03/15/12	MDP	FINAL DESIGN
04/15/12	MDP	FINAL DESIGN
05/15/12	MDP	FINAL DESIGN
06/15/12	MDP	FINAL DESIGN
07/15/12	MDP	FINAL DESIGN
08/15/12	MDP	FINAL DESIGN
09/15/12	MDP	FINAL DESIGN
10/15/12	MDP	FINAL DESIGN
11/15/12	MDP	FINAL DESIGN
12/15/12	MDP	FINAL DESIGN
01/15/13	MDP	FINAL DESIGN
02/15/13	MDP	FINAL DESIGN
03/15/13	MDP	FINAL DESIGN
04/15/13	MDP	FINAL DESIGN
05/15/13	MDP	FINAL DESIGN
06/15/13	MDP	FINAL DESIGN
07/15/13	MDP	FINAL DESIGN
08/15/13	MDP	FINAL DESIGN
09/15/13	MDP	FINAL DESIGN
10/15/13	MDP	FINAL DESIGN
11/15/13	MDP	FINAL DESIGN
12/15/13	MDP	FINAL DESIGN
01/15/14	MDP	FINAL DESIGN
02/15/14	MDP	FINAL DESIGN
03/15/14	MDP	FINAL DESIGN
04/15/14	MDP	FINAL DESIGN
05/15/14	MDP	FINAL DESIGN
06/15/14	MDP	FINAL DESIGN
07/15/14	MDP	FINAL DESIGN
08/15/14	MDP	FINAL DESIGN
09/15/14	MDP	FINAL DESIGN
10/15/14	MDP	FINAL DESIGN
11/15/14	MDP	FINAL DESIGN
12/15/14	MDP	FINAL DESIGN
01/15/15	MDP	FINAL DESIGN
02/15/15	MDP	FINAL DESIGN
03/15/15	MDP	FINAL DESIGN
04/15/15	MDP	FINAL DESIGN
05/15/15	MDP	FINAL DESIGN
06/15/15	MDP	FINAL DESIGN
07/15/15	MDP	FINAL DESIGN
08/15/15	MDP	FINAL DESIGN
09/15/15	MDP	FINAL DESIGN
10/15/15	MDP	FINAL DESIGN
11/15/15	MDP	FINAL DESIGN
12/15/15	MDP	FINAL DESIGN

MONTGOMERY CO.,
MARYLAND

MAP GP 562
W.S.S.C. 212 NW 06
LOCATION: ASHBURTON

